

Propane Kit 340 Sweeper/Scrubber

Model:
340799

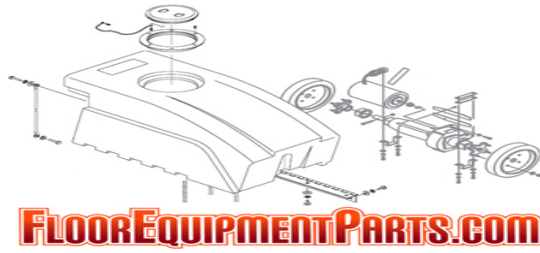

OPERATION

SERVICE

PARTS

CARE

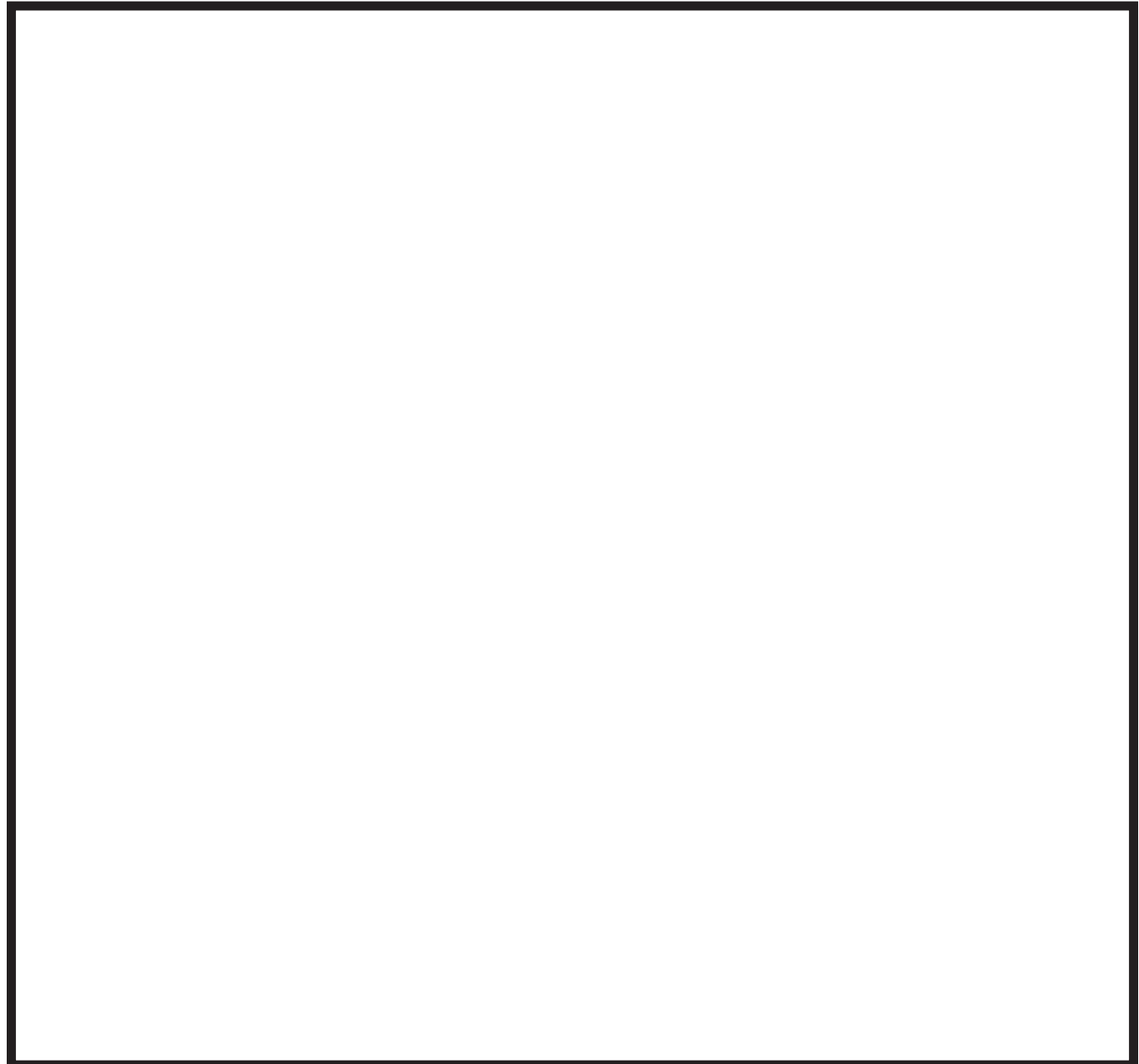

Revised

Minuteman[®]

CAUTION

1. Thread sealing compound should be used on all pipe thread fittings, being careful not to get any inside the fittings. This could allow excess compound to collect on valve seats and orifices and cause hazardous leakage and poor performance.
2. After piping is complete, turn on the gas and use a soap solution to check all fittings for leaks.

INSTALLATION INSTRUCTIONS 340 Propane Kit

1. Disconnect battery.
2. Drain fuel system.
3. Disconnect black wire from fuel solenoid, from left side of engine.
4. Install vaporizer assembly (Item no. 17-27) to end of oil reservoir using Item no. 36, 37 & 38.
5. Remove goof plug from top rear door. Install bulkhead fitting assembly (Item no. 32) thru hole. Hose (Item no. 30) crosses over air intake on top of door.
6. Install 14 lb. tank mounting bracket (Item no. 1) to top of cover using bolts (Item no. 39) provided.
7. Remove choke cable from engine.
8. Remove carburetor cover screen.
9. Remove the air cleaner cover and filter elements. Remove the hexhead bolts holding the air cleaner base to the engine. Set aside.
10. Remove the carburetor from the engine.
11. Remove fuel pump, fuel filter, and gasoline hoses from carburetor and overhead valve. Place bolt into existing fuel line and clamp off. Using 2" hose that was in-between fuel pump and overhead valve, clamp off tube where gas hose went in to carburetor using another bolt.
12. Remove the bolt holding the float bowl to the carburetor. Save the gasket from the bolt.
13. With a screwdriver, remove the brass gasoline fuel tube under the float bolt.
14. Drill out the hole carefully with a 1/4" diameter drill. Blow out all the chips.
15. Set the float bowl back in place. Make sure that the gasket is in place.
16. Install the fuel bowl bolt gasket (from 12 above) on the stud in the fuel tube (Item no. 28), included with the kit.
17. Insert the fuel tube into the carburetor and tighten gently. Do not use excessive force as the brass threaded part is thin and may be twisted off.
18. Remove the idle needle screw from the top of the carburetor near the manifold flange. Replace with the hollow idle screw (Item no. 29), furnished with the kit. Only tighten idle screw till snug.
19. Install the converted carburetor on the engine.
20. Connect idle hose (Item no. 16) to idle fitting on carburetor using a crimp clamp (Item no. 41). Connect vapor hose (Item no. 13) to fuel tube on carburetor using hose clamp (Item no. 42). Make sure spring inside hose is attached to the end with the fuel tube into the carburetor.
21. Install the air cleaner base and gasket to the carburetor and cross bracket with the original hexhead bolts. Note: Be sure to hook up the crankcase vent base on the inside of the air cleaner base as you install the base.
22. Attach lockout hose (Item no. 15) from top of the overhead valve to hose-barb on vacuum lockout valve using crimp clamp (Item no. 41). Connect other end of the vapor hose (Item no. 13) to top of load block (Item no. 18) using hose clamp (Item no. 42). Also connect remaining end of the idle hose (Item no. 16) to left side of the load block using crimp clamp (Item no. 41).
23. Install high pressure hose (Item no. 12) from (Item no. 31) to (Item no. 24).
24. See First Start-Up in order to adjust LP mixture properly.

FIRST START UP

The exact first time starting procedure is not an exactly defined process for each and every kit. However, there are certain steps which can help to get the engine running well enough to make fine tuning adjustments. The objective is to make some approximate mixture settings, and attempt to start the engine. Then depending on the results, either make further rough adjustments or proceed to the fine tuning.

Step 1. Turn both the main load and idle gas needle screws in finger tight. Then open the larger or main load screw three to four turns. Next open the idle gas screw 2 to 2 1/2 turns.

Step 2. Turn on the fuel supply and depress the primer button on the zero governor for an instant (approx. 1 sec.) and start the engine. If the engine fires but does not continue to run, turn the main load screw out 1/2 turn, re-prime if necessary, and restart. This step may have to be repeated several times to allow the engine to run well enough to proceed to the next step.

Step 3. Adjust the main load screw for maximum RPM and smoothest engine performance at governed speed. In most cases, turning the screw in leans the mixture and out enriches it.

Step 4. If the engine is required to run at idle speed, slowly let the engine return to idle speed. Adjust the idle gas needle screw to obtain a smooth idle operation. To set the proper idle speed, adjust the idle air adjustment on the throttle shaft. Do not attempt to set speed with the gas mixture adjustment.

Step 5. To check the adjustments, put the engine under its normal load and re-check the main load adjustment then return to idle and re-check this setting.

NORMAL OPERATION

To start the engine, depress the primer button on the zero governor (if provided) and start the engine. DO NOT USE A CHOKE, as it will most likely cause flooding.

When stopping the engine, if it is manual start and not equipped with a solenoid valve, turn off the fuel supply valve. Do not ground the ignition or choke the engine. For those engines that are equipped with solenoid shut-off valves, this is not a requirement but the supply valve should be closed if the engine will be left out of operation for an extended period to time.

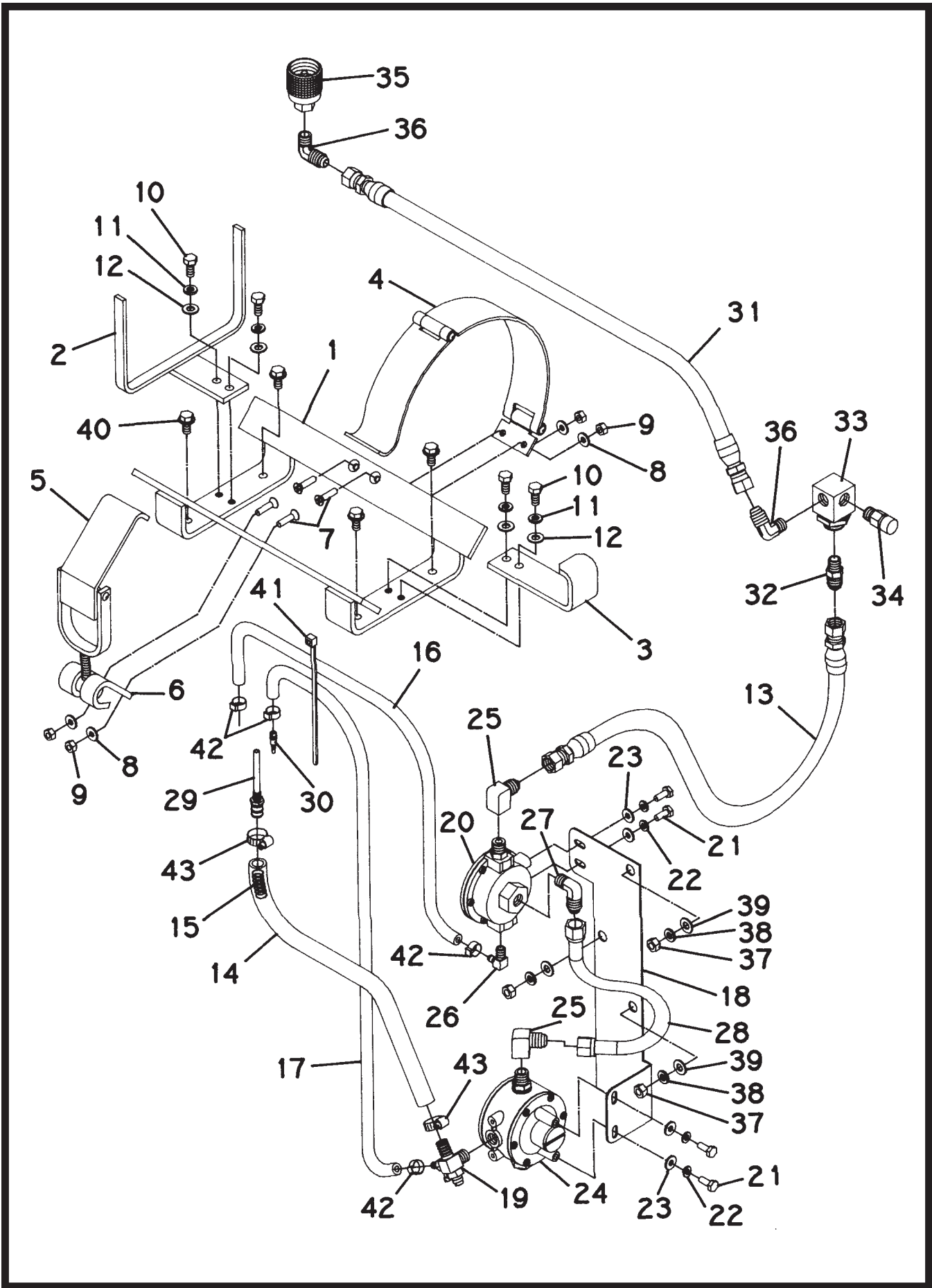

Parts List

Item	Part No.	Qty.	Description
1	341220	1	14 Lb. LP Tank Frame Weldment
2	341214	1	Tank Positioning Weldment
3	341223	1	Tank Retainer Bracket
4	341226	1	Tank Strap
5	341225	1	Buckle
6	341229	1	Claw
7	710584	4	Flathead Screw, 1/4-20 x 1.00
8	711505	4	1/4" Flat Washer
9	711373	4	1/4-20 Nyloc Hex Nut
10	713025	4	Hexhead Bolt 5/16-18 x .63 (G.5)
11	711545	4	5/16" Lock Washer
12	711506	4	5/16" Flat Washer
13	341201	1	High Pressure Hose
14	341202	1	1/2" ID Vapor Hose with Spring
15	831542	1	Spring .31 ID x .45 OD x 1.5 Long
16	341203	1	1/4" ID Lockout Hose 20" Long
17	341204	1	1/4" ID Idle Hose 24" Long
18	341081	1	Regulator Valve Mounting Bracket
19	341206	1	Load Block (133-17)
20	341207	1	Vacuum Lock-Off (320-01)
21	713001	4	Hexhead Bolt 1/4-20 x .63 (G.5)
22	711544	4	1/4" Lock Washer
23	711505	4	1/4" Flat Washer
24	74-145-A	1	Pressure Regulator (074-131)
25	80-111-A	2	ST Ell M 5/8-18 Flare FM 1/4 NPT
26	80-112-A	1	ST Ell M 1/4-18 NPT .25 Hose BARB
27	80-113-A	1	ST Ell 1/4-18 Flare M 3/8 NPT
28	80-115-A	1	Vapor Hose
29	341208	1	Fuel Tube (100-44)
30	341209	1	Idle Fitting (181-16)
31	341201	1	High Pressure Hose
32	341210	1	Flare M Connector 3/8 Tube 1/4 NPT
33	341212	1	Bulkhead Fitting
34	341213	1	Safety Relief Valve (556-01)
35	62-252-A	1	Female Safety Connector
36	80-113-A	2	ST Ell 1/4-18 Flare M 3/8 NPT
37	711319	3	Hex Nut 5/16-18
38	711545	3	5/16" Lock Washer
39	711506	3	5/16" Flat Washer
40	712042	4	Hexhead Bolt/Washer 5/16-18 x .63
41	828062	1	Cable Tie Large
42	828490	4	Crimp Clamp
43	829129	2	Micro-Seal Hose Clamp
xxx	341200	1	14 lb. Tank Mount Assembly Includes Item No's. 1-12
	314205	1	Complete Vaporizer Assembly Includes Item No's. 18-28
xxx	341211	1	Complete Bulkhead Fitting Assembly Includes Item No's. 31-36

LIMITED WARRANTY

Minuteman International, Inc. warrants to the original purchaser/user that this product is free from defects in workmanship and materials under normal use and service for a period of three years from date of purchase. In addition, Minuteman International, Inc. will, at its option, honor labor warranty claims for the first 12 months from date of sale, provided such claims are submitted through and approved by factory authorized repair stations. Minuteman International, Inc. will, at its option, repair or replace without charge, except for transportation costs, parts that fail under normal use and service when operated and maintained in accordance with the applicable operation and instruction manuals.

This warranty does not apply to normal wear, or to items whose life is dependent on their use and care, such as belts, cords, switches, hoses, rubber parts, electrical motor components or adjustments. Parts not manufactured by Minuteman International, Inc. such as engines, batteries, battery chargers, hydraulic pumps, and tires are covered by and subject to the warranties and/or guarantees of their manufacturers. Please contact Minuteman International, Inc. for procedures in warranty claims against these manufacturers.

Special warning to purchaser — Use of replacement filters and/or prefilters not manufactured by Minuteman International, Inc. or its designated licensees, will void all warranties expressed or implied.

A potential health hazard exists without exact original equipment replacement.

All warranted items become the sole property of Minuteman International, Inc. or its original manufacturer, whichever the case may be.

Minuteman International, Inc. disclaims any implied warranty, including the warranty of merchantability and the warranty of fitness for a particular purpose. Minuteman International, Inc. assumes no responsibility for any special, incidental or consequential damages.

This limited warranty is applicable only in the U.S.A. and Canada, and is extended only to the original user/purchaser of this product. Customers outside the U.S.A. and Canada should contact their local distributor for export warranty policies. Minuteman International, Inc. is not responsible for costs or repairs performed by persons other than those specifically authorized by Minuteman International, Inc. This warranty does not apply to damage from transportation, alterations by unauthorized persons, misuse or abuse of the equipment, use of non-compatible chemicals, or damage to property, or loss of income due to malfunctions of the product.

If a difficulty develops with this machine, you should contact the dealer from whom it was purchased.

This warranty gives you specific legal rights, and you may have other rights which vary from state to state. Some states do not allow the exclusion or limitation of special, incidental or consequential damages, or limitations on how long an implied warranty lasts, so the above exclusions and limitations may not apply to you.

Minuteman[®]

World Headquarters
Minuteman International, Inc.
111 South Rohlwing Road
Addison, Illinois 60101

Minuteman Canada, Inc.
2210 Drew Road
Mississauga, Ontario
L5S 1B1

(630) 627-6900
FAX (630) 627-1130

(905) 673-3222
FAX (905) 673-5161

988165
Printed in U.S.A.